



*Sue Adler*  
**KELLER WILLIAMS**  
**PREMIER PROPERTIES**



Cell: (973) 975-0197  
Office: (973) 376-0033 x 101  
VIP@SueAdler.com  
[www.SueAdler.com/21Sunset](http://www.SueAdler.com/21Sunset)

**21 Sunset Drive**  
**SUMMIT | NEW JERSEY**  
**sueadler**   
**THE #1 KELLER WILLIAMS TEAM IN NEW JERSEY team**

Each Keller Williams office is independently owned and operated.



Thoughtful renovations and updates have transformed this lovely Dutch Colonial into the showplace you see today. Through four beautifully finished levels, quality craftsmanship and attention to detail are on display. In addition to elegant main living areas and generous bedrooms, bonus spaces accommodate a wide range of lifestyles. The easy, open floor plan is designed for comfortable daily living and entertaining.

## THE FIRST LEVEL

- ◆ The center-hall foyer greets you with hardwood floors, recessed lighting, crown molding and chair rail detailing. Stairs lead the way up to the second level or down to the lower level.
- ◆ The living room features hardwood floors, recessed lighting, crown molding and the comfort of a gas fireplace with built-in shelves above the mantel.
- ◆ The formal dining room welcomes your dinner guests with hardwood floors, recessed lighting, crown molding and French doors to the breakfast room.
- ◆ The designer kitchen features custom white cabinets with under-cabinet lighting and are topped with granite counters and a mosaic tile backsplash. Dark wood distinguishes the center island breakfast bar with granite counter, all set beneath a custom pendant light. Appliances include a GE side-by-side refrigerator, Viking gas range, built-in wall oven, microwave/convection, warming drawer and Viking dishwasher. Recessed lighting illuminates the work areas and the adjoining breakfast room. Kitchen also features a utility and pantry closet with built-ins.
- ◆ The breakfast room is awash in sunlight courtesy of tall windows and French doors to the deck. A built-in entertainment bar features a mini-fridge and bar sink.
- ◆ The family room has hardwood floors, crown molding, recessed lighting, windows on three sides and a gas fireplace with a window above the mantel.
- ◆ The office has a tile floor and a built-in desk. There is access to the deck and a side door with steps to the outside.
- ◆ The laundry room features a tile floor, full size washer and dryer, laundry sink, closet and access to a service entry with access to the 2-car garage and the covered wraparound front porch
- ◆ The powder room features a vanity with marble counter top.



## THE SECOND & THIRD LEVELS

- ◆ The enormous master bedroom includes plenty of space for large furniture pieces and a separate sitting area. The tray ceiling with recessed lighting adds to the sense of space. A cavernous walk-in closet with built-ins houses extensive wardrobes.
- ◆ The luxurious master bath features a marble tile floor, furniture quality vanities with stone counter tops, large framed mirrors and a make-up table. There is a walk-in steam shower and a whirlpool tub with marble surround.
- ◆ Bedroom 2 has hardwood floors, crown molding, recessed lighting, closet and a full en- suite bath.
- ◆ Bedroom 3 features wall-to-wall carpeting, crown molding and closet.
- ◆ Bedroom 4 has wall-to-wall carpet, closet, built-ins, crown molding and a full en suite bath
- ◆ The hall bath comes equipped with a tile floor, vanity with granite counter and a tile shower/tub
- ◆ The bonus room has wall-to-wall carpet, a cathedral ceiling, recessed lighting, four single closets and a walk-in closet across from a full en-suite bath with shower/tub.
- ◆ The spacious central hallway includes front and rear staircases to the main level and an additional staircase to the third level.
- ◆ A multi-purpose room occupies the third level. Wall-to-wall carpet, three front dormer windows, built-ins and access to attic storage.



## LOWER LEVEL

- ◆ Finished in keep with the standards of the rest of the house, the recreation room has wall-to-wall carpet, beadboard wainscoting, recessed lighting and built-in cabinets and shelves for storage of games and toys.
- ◆ The media room would be perfect as a home theater with wall-to-wall carpet and recessed lighting.
- ◆ The guest room has wall-to-wall carpet, built-in storage and a full en suite bath with tile shower
- ◆ Perfect for an aficionado, the wine cellar has a tile floor, custom mahogany racks, granite counter tops and is climate controlled.
- ◆ The utility room has ample storage space.



## IMPROVEMENTS

- ◆ Wraparound front porch - 2011
- ◆ New bluestone patio - 2011
- ◆ New sidewalks - 2010
- ◆ New garage door system with panel and security code entrance - 2010
- ◆ Home theater room with surround sound - 2010
- ◆ Heated and finished 2-car garage - 2010
- ◆ 2005 Renovation includes HardiPlank "no rot" trim on the steps and windows, new copper gutters, new windows, fully wired and FIOS ready, new roof with 50-year guarantee, 3 commercial air conditioners, 5-zone baseboard heating with two boilers, rough plumbing on the third level for a future full bath, custom boulder retaining wall, new landscaping, underground sprinkler system and dry well.

## ADDITIONAL FEATURES

- ◆ Private guest or in-law suite with full bath
- ◆ Outdoor fireplace with blue stone patio
- ◆ Mahogany floor and new ceiling fans in the wraparound porch
- ◆ Surveillance cameras throughout the house and all play areas with monitor from the Kitchen and Master bedroom TVs
- ◆ Brinks security system
- ◆ Paved driveway with Belgian block curbs and additional parking
- ◆ Deep, private backyard
- ◆ Professionally landscaped property includes mature trees, foundation shrubbery, specimen plantings and established lawns

## PROPERTY PARTICULARS

- ◆ Lot Size: .78 Acre
- ◆ 2011 Taxes: \$27,676

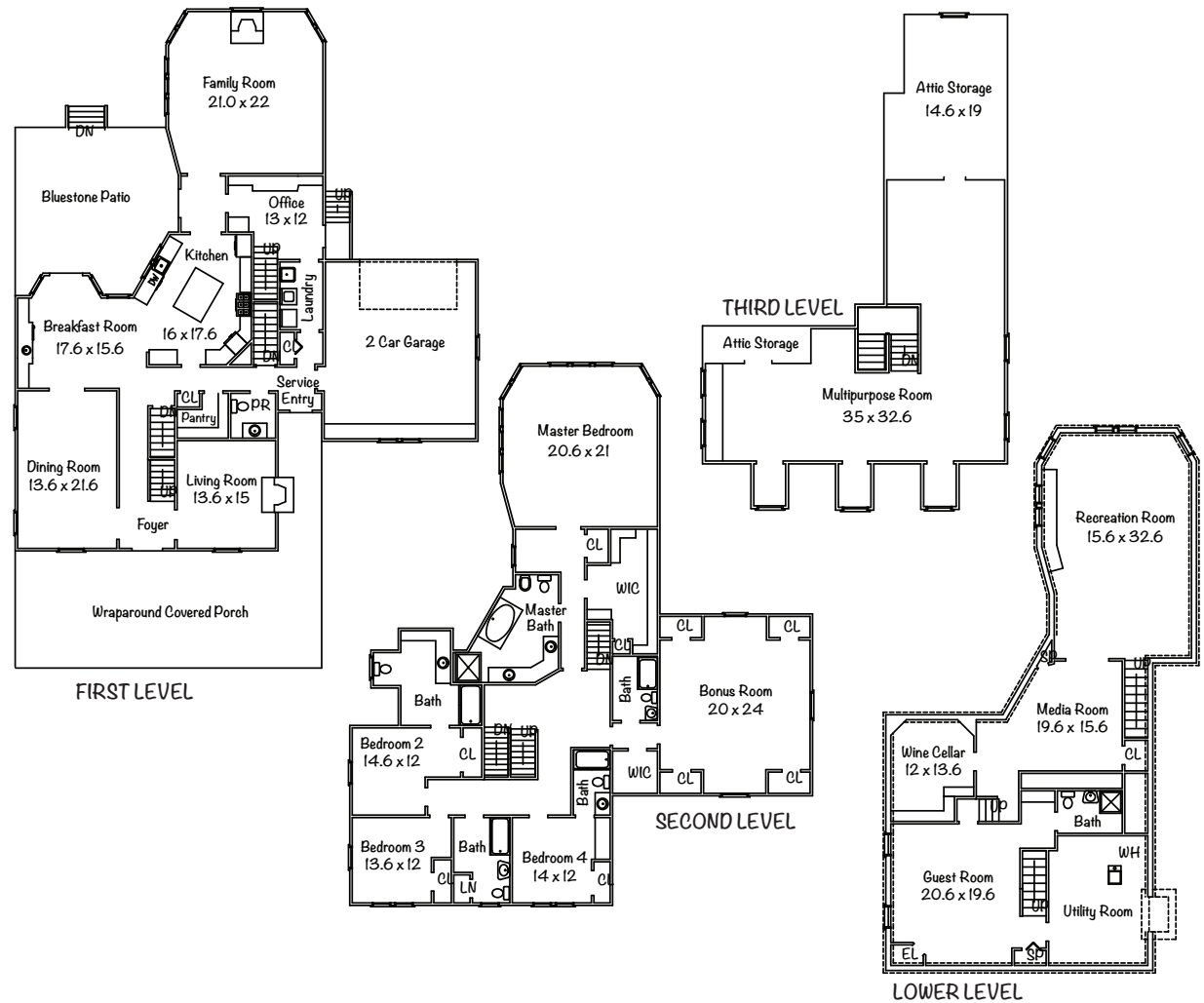

While this fine home enjoys enormous curb appeal, there is ample space for outdoor enjoyment. The wraparound front porch evokes images of warm days, cool beverages and the company of friends and loved ones. An afternoon barbecue or intimate al fresco dinner are best served on the bluestone patio, complete with outdoor fireplace. Located on a quiet, neighborhood street, this home is perfectly positioned. The New Providence train station with commuter access to NYC is only a few blocks away. Also within blocks are the Summit Tennis Club, fabulous downtown shopping, the Franklin Elementary School and the Clearwater Swim Club.

With immaculate interior spaces, a lovely setting and prime location, this is an incredible opportunity to take advantage of all Summit has to offer, in complete comfort and supreme style.

**Disclaimer:** Information contained in this brochure is deemed reliable but not guaranteed and should be independently verified by the buyer(s). Keller Williams Realtors and agents acting on their behalf for the purpose of creating this brochure are not responsible for typographical errors, misprints or misrepresentations and are therefore held totally harmless. This listing is subject to price changes and/or withdrawal without prior notice.