

6 Cherrywood Circle

West Orange, New Jersey



Sue Adler
KELLER WILLIAMS
PREMIER PROPERTIES

sueadler 
THE #1 KELLER WILLIAMS TEAM IN NEW JERSEY team

Each Keller Williams office is independently owned and operated.



A short drive through the winding tree-lined streets of West Orange will bring you to 6 Cherrywood Circle, an appealing contemporary ranch that boasts true, one-floor living along with the ultimate in privacy.

Step right into the open and airy Living Room space where spectacular backyard views of lush golf course greenery provide the perfect backdrop as you relax in front of the fireplace boasting a full-wall stone mantel and surround. It's a truly impressive setting for entertaining family and friends or simply putting your feet up after a long day of work. The adjacent Dining Alcove with its striking glass block accent wall is ready for you to host your next dinner party in complete comfort and style and just steps away is the updated eat-in Kitchen featuring granite countertops, stainless appliances and a charming brick fronted fireplace.





Everyone will find his or her own personal retreat in one of three bedrooms located in the left wing of the home. Each features carpet, plenty of closet space, a stylish designer ceiling fan/light and blinds. A completely remodeled Hall Bath meets everyone's needs with its tiled shower over tub, sink vanity, attractive granite countertop and plenty of cabinet storage. The spacious Master Bedroom Suite has a well equipped, handicap accessible en suite bath and plenty of storage. A Laundry/Utility Room, plenty of hall closet space and a large cedar closet round out the bedroom wing.

And there's more...enjoy your private outdoor oasis as you bask in the sun's rays after taking a dip in the heated in-ground pool, while barbeque meals are a pleasure as you gather on the brick paver patio for stunning fairway views.

Sitting serenely on a small cul de sac street that backs up to a private golf course, this home is a special quiet retreat with convenient access to NYC transportation as well as nearby shopping and restaurants. It's the perfect place to call your next home.

Inside and Out...

THE FLOOR PLAN

Main Level

- Entry Foyer with ceramic tile floor, front door with decorative glass panes, glass block wall and access to Laundry/Utility Room
- Living Room with carpet, recessed lighting, 2 sets of sliding doors to backyard, patio and pool, large brick fireplace with bluestone hearth and surround
- Dining Room (open to Living Room) with large picture window facing front yard, carpet and glass block accent wall
- Kitchen with white custom cabinets with decorative glass front panels and lighting, faux painted walls, center island, granite countertops and backsplash, ceramic tile floor, baseboard heat, fireplace with white painted brick surround, sliders to patio, recessed lights, under-counter lighting, stainless appliances including KitchenAid oven with convection, electric cooktop, Electrolux dishwasher, Samsung refrigerator/freezer, Marvel wine refrigerator and bottle/glass storage, microwave, stainless sink with water filter, full pantry/coat closet, additional pantry, eat-in Breakfast Room with designer ceiling fan/light, window treatments and access to 2-car garage
- Laundry/Utility Room with washer/dryer, cabinets, recessed lighting and window
- Bedroom Hallway with carpet, recessed lighting, cedar closet and large linen/storage closet with shelving
- Bedroom #1 with carpet, recessed lights, designer ceiling fan with light, closet, large window and wood blinds
- Bedroom #2 with carpet, recessed lights, designer ceiling fan with light, double closet with shelving, 2 large windows and wood blinds
- Master Bedroom featuring carpet, designer ceiling fan with light, 3 large windows with blinds and En Suite Bath with double sink vanity with granite countertop and cabinets below, 3 double closets with shelving, tile floor, tiled stall shower, recessed lights, additional storage cabinet and window with blinds
- Hall Bath with granite topped vanity with cabinets, large mirrored wall above vanity, ceramic tile floor, faux painted walls, shower over tub with ceramic tiled walls, recessed lights, window with blinds

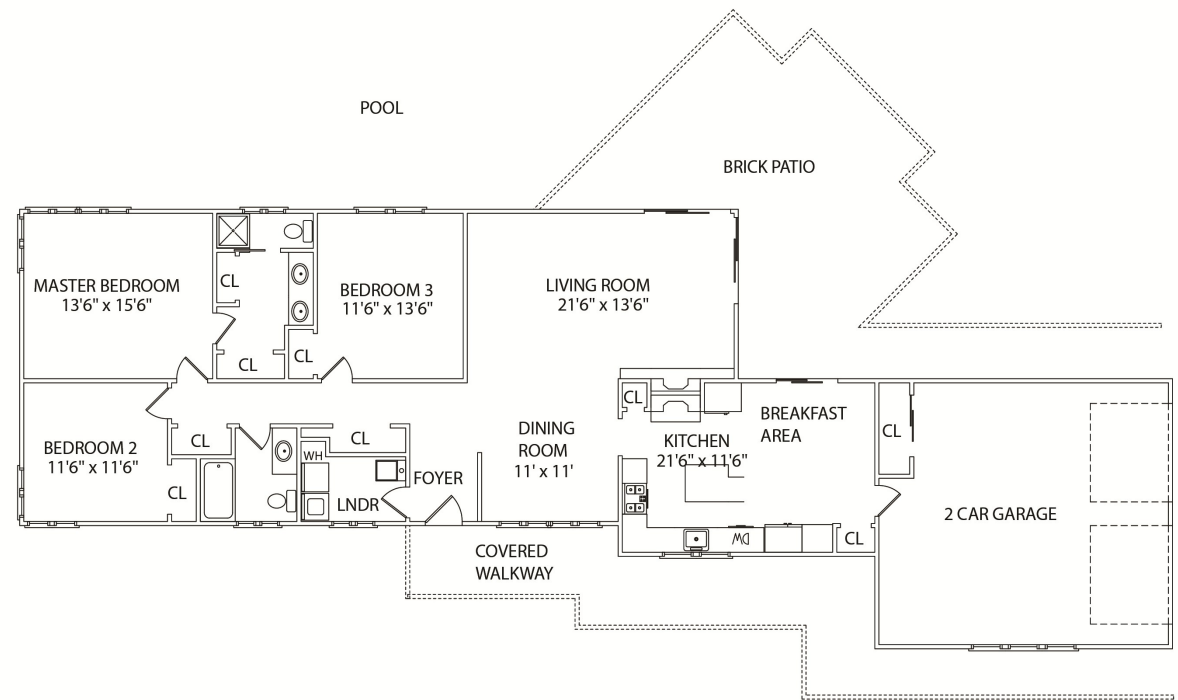

NOT TO SCALE - This floor plan is provided for illustration purposes only. Room positions and dimensions are approximate and should be independently measured for accuracy.

Updates and Additional Features

- True one floor living
- Forced air heat/AC with humidifier on furnace
- Large, heated in-ground pool with surrounding wet laid deck and brick retaining wall, brick paver patio with direct gas line for BBQ grill and views of adjacent golf course
- ADT security system (installed 2012)
- Roof (2008)
- Exterior painting (2008)
- Interior painting (2013)
- Hall Bath full remodel (2006)
- Hot water heater (2015)
- Dishwasher (2015)
- Refrigerator (2014)
- Nearby jitney service to South Orange train station



Cell: (973) 464-9129
Office: (973) 376-0033 x101
Sue@sueadler.com
www.sueadler.com/6Cherrywood

