

20 Ridge Drive East

Berkeley Heights, New Jersey



Sue Adler
KELLER WILLIAMS
PREMIER PROPERTIES

sueadler 
THE #1 KELLER WILLIAMS TEAM IN NEW JERSEY team

Each Keller Williams office is independently owned and operated.



Welcome to 20 Ridge East, the perfect blend of gracious living and phenomenal vistas. This is an extraordinary opportunity to own this pristine home exquisitely situated on top of a scenic ridge with gorgeous views of the Watchung Reservation.

Walk up the herringbone patterned brick walkway amongst professional gardens and you know you have arrived somewhere magical. Enter the Entry Foyer and admire the chic tumbled tiled floors and modern light fixture with filament lighting. Curl up by the fire in the sun-drenched Living Room complete with gleaming hardwood floors and custom built in.

Dinner parties are a dream in the magnificent Dining Room featuring a charming chair rail and stunning views of the outdoors. The Dining Room connects easily to the fabulous Gourmet Chef's Kitchen that will satisfy any cook's desire. Creamy white custom wood cabinetry with gorgeous custom island, breakfast peninsula, granite countertops, breakfast area and top of the line stainless steel appliances make the Kitchen exceptional. In addition, the Kitchen's built in desk area is sure to be "command central" for any busy family. Doing laundry is a pleasure in the luxurious Laundry Room with custom built ins, granite countertops and tons of storage so that not a thing will be out of place. A Powder Room renovated to perfection rounds out the First Level.

When you are ready to retire for the evening, flow easily up the staircase to find the roomy and sunlit Master Suite complete with an arched ceiling, dual closets and well-appointed Master Bath. Three additional roomy Bedrooms boast great closet space and views of the lush property beyond. A tastefully updated Full Hallway Bath, with its own Linen Closet, rounds out the Second Level.



And that's not all! The fully finished Lower Level provides plenty of additional living space. A spacious Recreation Room with a wood burning fireplace is the perfect spot for family game night. The Recreation Room has walkout access to a charming pebble stone patio perfect for rest and relaxation. A large Office, with plenty of room for desks and storage, rounds out the Lower Level.

The real star of this property is the outdoor deck easily accessed from the Chef's Kitchen through a single lite French door. The deck is the perfect spot for al fresco dining, lounging or cocktails after a long day. Stunning views of the Watchung Reservation will provide endless hours of enjoyment. Fabulous brickwork, meandering bluestone paths, a classic arbor and blooming perennials are also sure to captivate.

Inside and Out...

First Level

- Entry Foyer featuring tile flooring, baseboard molding, crown molding with dentil detail, semi-flush mount light fixture with filament lighting, stairway to 2nd Level, wainscoting
- Powder Room featuring tumbled tile flooring and wainscoting, pedestal sink, 2 sconces, woven roman shade, medicine cabinet
- Living Room featuring baseboard molding, crown molding with dentil detail, recessed lighting, wood-burning fireplace (chimney cleaned 2015) with custom millwork mantel and brick surround, open shelving, built-in cabinetry with lower level concealed storage and open shelving on top
- Gourmet Chef's Kitchen featuring travertine limestone flooring, tile backsplash, 2 stainless steel sinks, custom creamy white cabinetry with soft close, glass door cabinetry, large wood island, breakfast bar with seating for 2, granite countertops, recessed lighting, pendant lighting, Viking stainless steel six burner stove, Kitchen Aid stainless steel dishwasher, Kitchen Aid stainless refrigerator (new 2014 with extended warranty), GE Profile stainless steel built in microwave, built in desk area with honed granite countertop and open shelving above, new garbage disposal, Breakfast Area with wine shelving
- Dining Room featuring hardwood floors, arched ceiling, baseboard molding, semi-pendant light fixture, chair rail
- Mud room featuring tile flooring, baseboard molding, storm door to deck, coat closet
- Laundry Room featuring lots of built in cabinetry, granite countertops matching kitchen countertops, stainless steel sink, LG stainless steel front loader washer and dryer, recessed lighting, baseboard molding
- 2 car garage with new silent electric doors (2014) with extended warranty

Second Level

- Second Floor Landing featuring hardwood floors, baseboard molding, crown molding, semi-pendant light fixture with filament lighting, linen closet
- Master Bedroom featuring hardwood floors, baseboard molding, arched ceiling with 2 dormers, light fixture with drum shade, dual closets
- Master Bathroom featuring tile flooring, tile wainscoting, shower, wood vanity, tilt mirror, 2 light sconce, fan
- Bedroom #2 featuring hardwood floors, baseboard molding, crown molding, flush mount light fixture, closet
- Bedroom #3 featuring hardwood floors, baseboard molding, crown molding, flush mount light fixture, closet
- Bedroom #4 featuring hardwood floors, baseboard molding, crown molding, flush mount light fixture, closet
- Full Hall Bath featuring tile flooring, tile wainscoting with decorative detail, bath/shower combination with jets, tile surround in shower, linen closet with floor to ceiling shelving, wood vanity, flush mount light fixture, 4 light sconce

Lower Level

- Carpeting staircase to Lower Level
- Hallway with tile flooring, baseboard molding, access to storage room, cedar closet
- Walk in Pantry with shelving (and 3rd water heater in closet)
- Recreation Room featuring tile flooring, recessed lighting, fireplace with wood mantel and brick surround, door with walkout access to pebble stone patio
- Office featuring tile flooring, recessed lighting

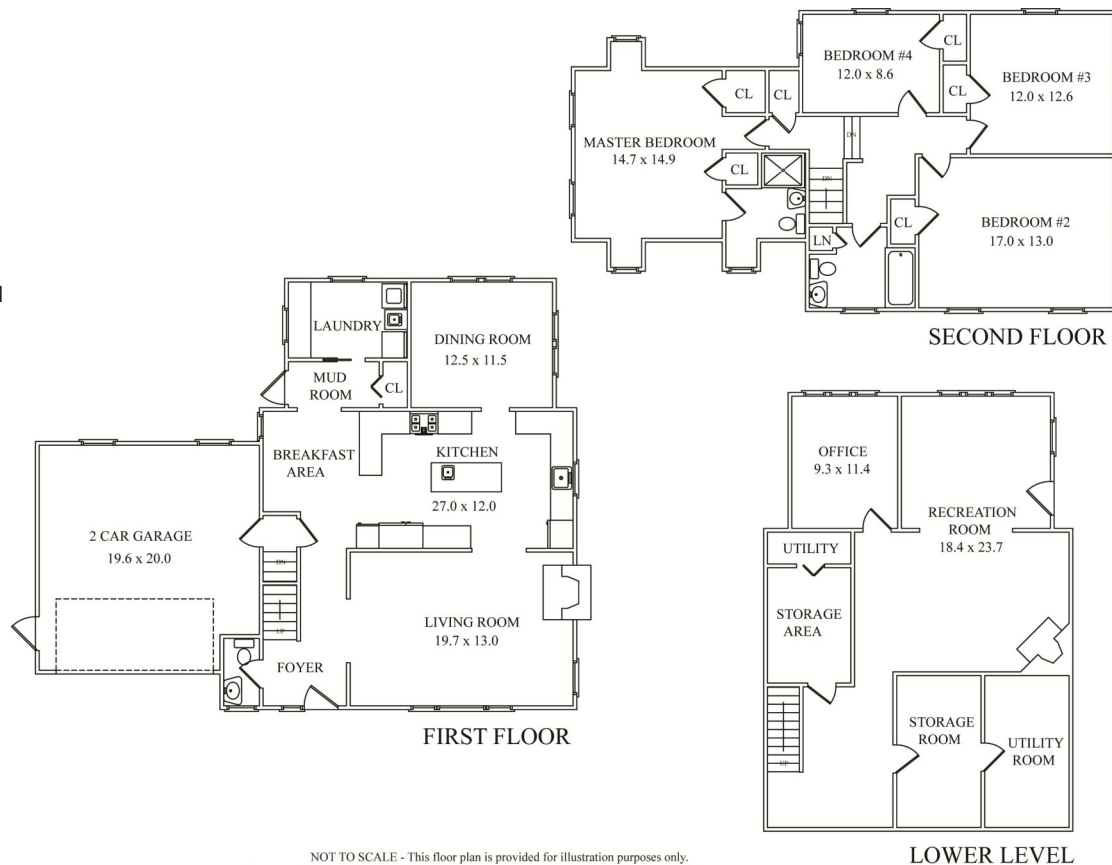

Additional Features and Upgrades

- 2 car garage + additional parking
- New, silent garage doors (2014)
- Heat/AC Forced Air, 1 zone (new 2015)
- Basement redone, new tile and heating (2016)
- Alarm System

Backyard

- Large, maintenance-free composite (Trex) deck
- Stunning views of Watchung Reservation
- Pebble stone patio with picket fence and arbor
- Shed under deck
- Professional landscaping and hardscaping

Sue Adler
KELLER WILLIAMS
PREMIER PROPERTIES



Cell: (973) 936-9129
Office: (973) 376-0033 x101
Sue@sueadler.com
www.sueadler.com/20RidgeEast