

92 Westminster Road

Chatham, New Jersey

Sue Adler
KELLER WILLIAMS
PREMIER PROPERTIES

sueadler 
THE #1 KELLER WILLIAMS TEAM IN NEW JERSEY team

Each Keller Williams office is independently owned and operated.



Situated in a picturesque neighborhood in the Wickham Woods section of Chatham and blocks to schools, this move-in ready Colonial has been maintained by its current homeowners with love and care, both inside and out.

Sitting on a little less than half an acre of land with manicured trees and shrubs, the driveway guides you to the front door and into the foyer, where your first glimpse of the open and airy floor plan of well-planned living and entertaining spaces comes into view. Enjoy entertaining in the formal living room and dining room with hardwood floors. The spacious family room features wood fireplace with brick surround, and with access to the kitchen- it is sure to be a popular spot. The centrally located eat-in kitchen with abundant counter space allows you take on all your cooking endeavors from quick on the go meals to holiday feasts. Located just down the hall is a bedroom for overnight guests and family alike, powder room and laundry area.





On the second level, four bedrooms and two full baths assure a restful night's sleep for all. The Master bedroom has hardwood floors and large walk-in closet and the functional master bathroom features tile floor and stall shower.

And there's more....the finished lower level includes a spacious recreation area, storage room, and access to the two-car garage.

Outside, the rear deck is ready for all your summer barbeques, overlooking the private rear yard. This house has so many options to grow with your changing family, coupled with its sought after location, making 92 Westminister Road a perfect place to call home.

Inside and Out...

First Level

- Entry hall with hardwood floor and coat closet
- Bedroom with carpet and closet
- Laundry with tile floor and cabinets for storage
- Family room with hardwood floor, wood fireplace with brick surround and recessed lighting
- Powder room with tile floor
- Kitchen with tile floor, granite counters, tile backsplash, and recessed lighting
- Dining room with hardwood floor and chair rail detail
- Living room with hardwood floor

Second Level

- Bedroom with hardwood floor and walk-in closet
- Bedroom with hardwood floor and closet
- Bedroom with hardwood floor and closet
- Bathroom with tile floor and shower over tub
- Master bedroom with hardwood floor and walk-in closet
- Master bathroom with tile floor and stall shower

Lower Level

- Recreation room with carpet
- Storage room
- Access to two-car garage

THE FLOOR PLAN

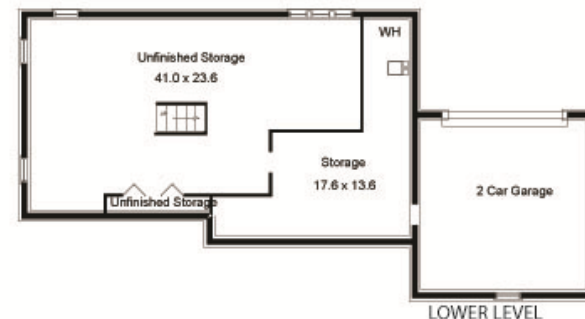

NOT TO SCALE - This floor plan is provided for illustration purposes only. Room positions and dimensions are approximate and should be independently measured for accuracy.

Additional Features

- Additional Features and Updates
- New deck (2014)
- All bathrooms painted (2012)
- Powder room (2011)
- Hot water and furnace (2001)
- 1 zone heat and central air



Cell: (973) 464-9129
 Office: (973) 376-0033 x101
 Sue@sueadler.com
 www.sueadler.com/92westminster

Sue Adler
KELLER WILLIAMS
 PREMIER PROPERTIES

sueadler 
 THE #1 KELLER WILLIAMS TEAM IN NEW JERSEY team