

SURVEY OF PROPERTY SITUATED IN GREAT HILLS, TOWNSHIP OF MILLBURN, ESSEX CO., N.J.

Tax Block 1810
Lot 15

SUBJECT TO OUTSTANDING RIGHTS IN AND TO A STRIP OF LAND HAVING A DEPTH OF 2.42 FEET AND A WIDTH OF APPROXIMATELY 50. FEET IN THE NORTH-EASTERN CORNER OF THE PREMISES

Fence on line N 81° 50' 55" W 70.00
C.L. fence

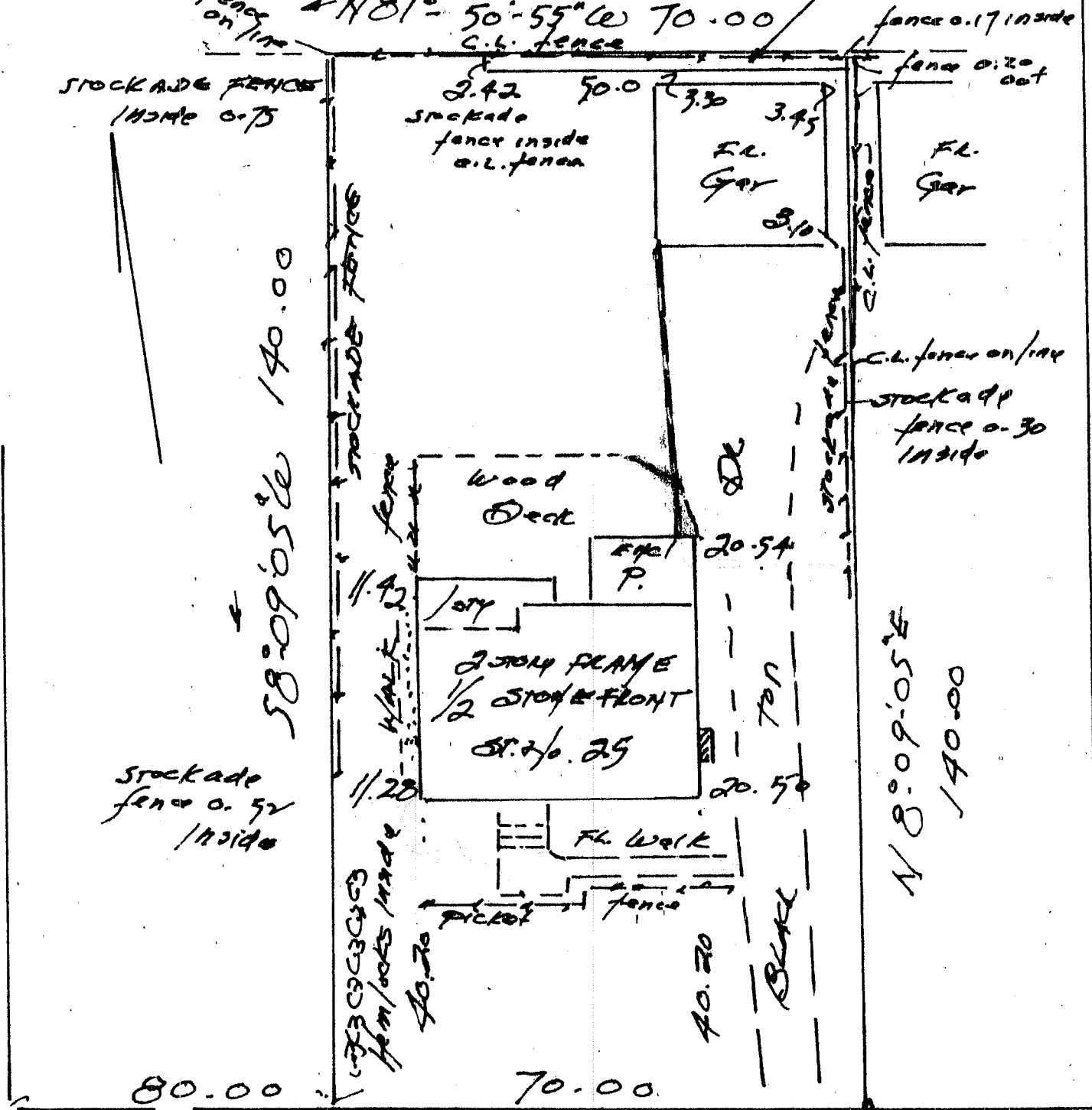

S 81° 50' 55" E

PINE TERRACE WEST
50.00 wide
(formerly Pine Terrace)

Certified to: Robert M. Fisher and Wendy K. Fisher
Bernard Spensieri, Esq.
Penn Federal Savings Bank, its Successors and/or Assigns
First American Title Insurance Company

VITO P. MARCANTONIO
32 SPRING STREET
MILLBURN, N.J.
LIC. LAND SUR #13,904
C/O. Thomas J. ...
SCALE: 1" = 50'
DATE: Dec. 27, 1994