

14 Yarmouth Road

Chatham, New Jersey



Sue Adler
KELLER WILLIAMS
PREMIER PROPERTIES





Quality craftsmanship and attention to detail are evident in every aspect of this 6 year young cul-de-sac Colonial, blocks to schools and a short distance to downtown Chatham and trains direct to NYC (50 minutes). Loaded with curb appeal, the bluestone front walkway guides you to the front porch and into the entry, leading to the open and airy floor plan with approximately 4,000 SF of living space. Rich hardwood floors extend throughout all three levels, as architectural detailing and abundant windows distinguish each room. This fine home features four levels of superior living and entertaining space that extend to a deck overlooking a professionally landscaped rear yard.

The open and inviting floor plan of the first level includes dining and living rooms, family room with custom Cherry built-in entertainment center and gas fireplace. At the heart of this home is the Kitchen inspired by any cook's dream. With Cherry cabinetry and top-of-the-line Thermador appliances -- refrigerator, 6-burner range and oven, Bosch dishwasher, Viking warming tray and Dacor microwave - the abundant counter space, two sinks (one for prep) and granite center island with breakfast bar make cooking and entertaining both gratifying and delightful. Completing this level is a powder room and mudroom with access to the garage.

On the second level 3 bedrooms and 2 full bathrooms assure a restful night sleep for all. The private Master bedroom features walk-in closet with custom shelving and the spa-like master bath, complete with Jacuzzi tub, vanity with double bowl sinks, walk-in stall shower and separate powder room. The second bedroom on this level features a spacious walk-in closet, making an overnight guest more than comfortable.

The third level is home to the fourth bedroom suite with full bathroom featuring stone backsplash and walk-in shower. Additional storage is also provided on this level.

And there's more...the finished lower level has a recreation room with tile floor, full bathroom with stall shower and plenty of closets and storage space.

Outside, the private professionally landscaped yard with manicured trees and shrubs is ready for all your outdoor hobbies and the two-tiered rear Trex deck is sure to be a popular spot for barbecuing and dining al fresco. This house has so many options to grow with your changing family, coupled with its sought after location, making 14 Yarmouth Road a perfect place to call home.

Inside and Out...

First Level

- Living room with hardwood floor, crown molding and recessed lighting
- Dining room with hardwood floor, crown molding and recessed lighting
- Family room with hardwood floor, Cherry wood built-in entertainment unit, gas fireplace and recessed lighting
- Kitchen with hardwood floor, center island with breakfast bar, Schuler Cherry cabinetry, tumbled stone backsplash, two sinks (one-hammered copper prep sink), breakfast area, high end appliances including- 6 burner, 5 point Thermador oven and range, wood paneled Thermador refrigerator, Bosch dishwasher, Dacor microwave and Viking warming drawer
- Mudroom with slate tile floor and access to garage
- Powder room with tile floor and vanity
- Coat closet

Second Level

- Master bedroom with hardwood floor, walk-in closet with custom shelving, crown molding and recessed lighting
- Master bathroom with stone tile floor, vanity with double sinks, Jacuzzi tub and stall shower and separate powder room
- Bedroom with hardwood floor, large walk-in closet with custom shelving, crown molding and recessed lighting
- Bedroom with hardwood floor, closet, crown molding and recessed lighting
- Laundry room with tile floor and Miele front load washers
- Bathroom with stone tile floor, shower over tub with tile backsplash
- Linen closet

Third Level

- Bedroom with hardwood floor, closet and recessed lighting
- Bathroom with tile floor, stall shower with stone backsplash
- Storage

Lower Level

- Recreation room with tile, crown molding and recessed lighting
- Bathroom with tile floor, stall shower with tile backsplash and linen closet
- Utility room
- Closets (2)

THE FLOOR PLAN

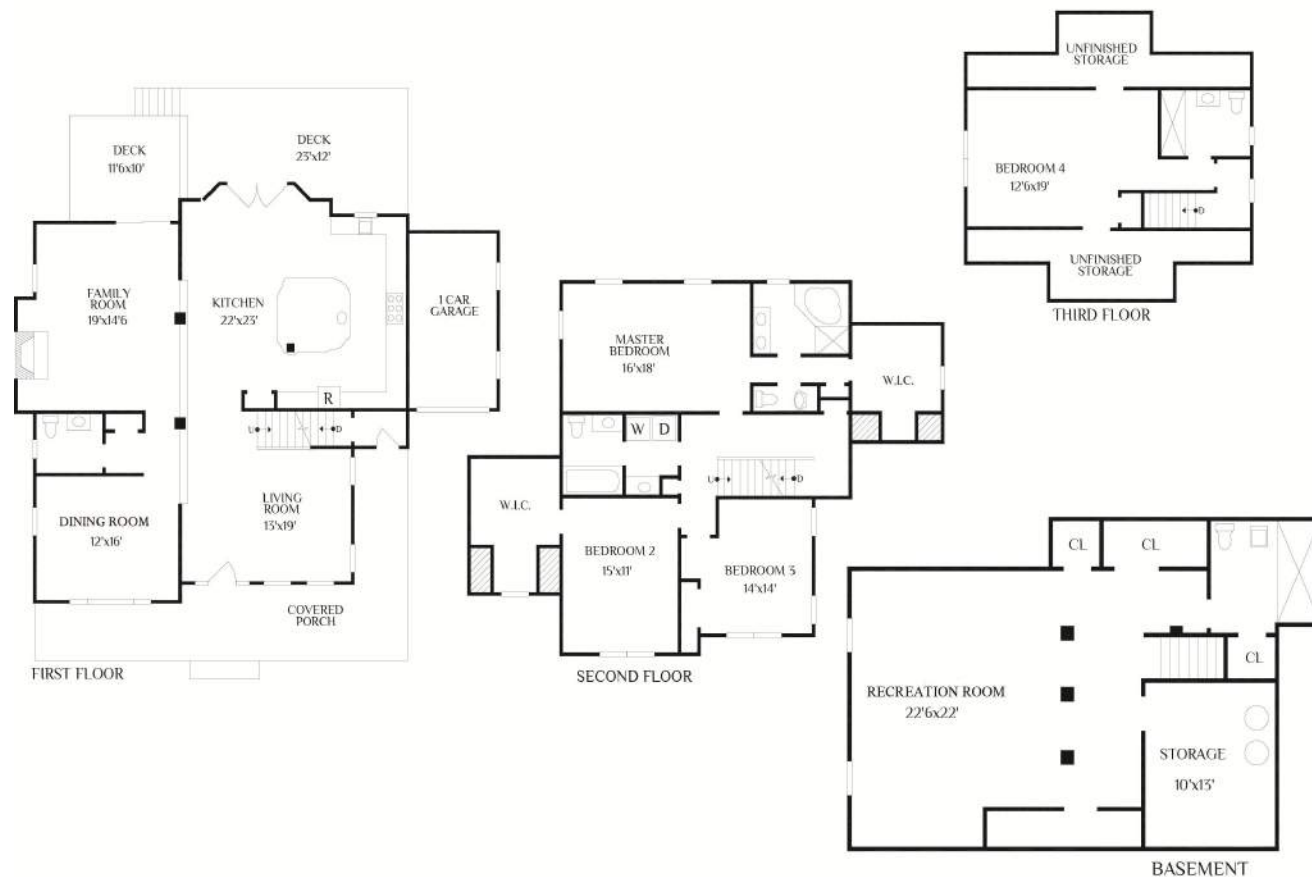

NOT TO SCALE - This floor plan is provided for illustration purposes only.
Room positions and dimensions are approximate and should be independently measured for accuracy.

Additional Features and Updates

- Hardiplank siding
- Two-tiered Trex deck
- Timberline roof
- Wired for stereo system (1st level and outside)
- Underground lawn sprinkler system (8 zones)
- 1 car garage with 10ft ceilings and custom shelving
- Gas Generator hook-up
- Stone front façade and open front porch with columns
- Bluestone walkways (2) to rear yard
- Hardwood floors throughout
- Crown molding throughout
- Hunter Douglas Silhouette blinds
- Professionally landscaped yard
- Security system (wireless)
- 3 units/3 zone forced hot air and central air with humidifier system
- 2-50 gallon hot water heaters



Sue Adler
KELLER WILLIAMS
PREMIER PROPERTIES

Cell: (973) 464-9129
Office: (973) 376-0033 x101
Sue@sueadler.com
www.sueadler.com/14yarmouth

sueadler 
THE #1 KELLER WILLIAMS TEAM IN NEW JERSEY team