

## Location, Location, Location

# 140 Hillside, Chatham



### Specifications

MLS # 2947726  
Year Built: 1954  
Lot Size: 104x108  
Bedrooms: 3  
Bathrooms: 1.5

Features: Totally updated kitchen, main level hardwood floors, flat back yard, large deck with built in seating.

Looking for a home to move right into? Then look no further. This home with its newer kitchen, stainless steel appliances and granite countertops makes a perfect place to call home. Hard wood floors flow under foot from the second you step in the door. The two hardwood and one carpeted bedrooms upstairs provide plenty of room for both family and guests alike. Down stairs you find a family room with fireplace, built in media center and a finished work space with linoleum flooring, perfect for a work out room or work shop. Off the glassed in three season room you will find a flat back yard featuring a large deck with seating.

### Entry Level

- Living room with hardwood floors.
- Dining room with direct access to three season room and kitchen.
- Kitchen with new cabinetry, granite countertops and stainless steel appliances.
- Glassed in three season room with direct access to large deck and flat back yard.

### Upper Level

- Two hardwood and one carpeted bedrooms
- Master bedroom with half bath and double closets.

### Lower Level

- Family room with fireplace and built in entertainment center.
- Finished space with laundry machines, perfect for work shop or work out room.



**sueadler**   
THE #1 KELLER WILLIAMS TEAM IN NEW JERSEY **team**

Cell: (973) 632-2767 Office: (973) 376-0033  
Email: Laurie@SueAdler.com [www.SueAdler.com/140Hillside](http://www.SueAdler.com/140Hillside)



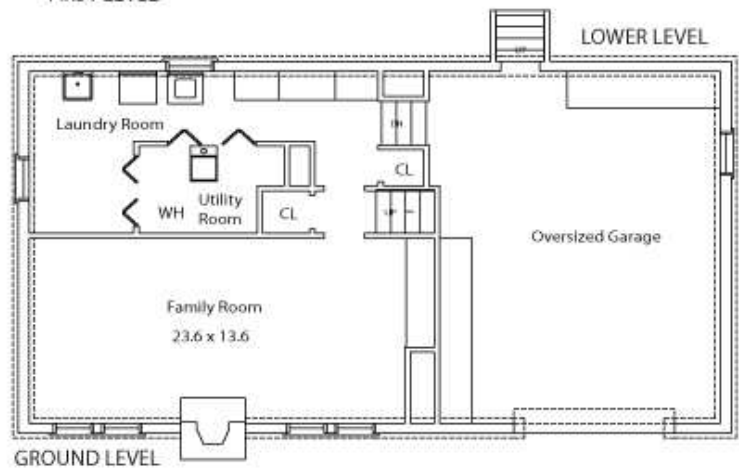
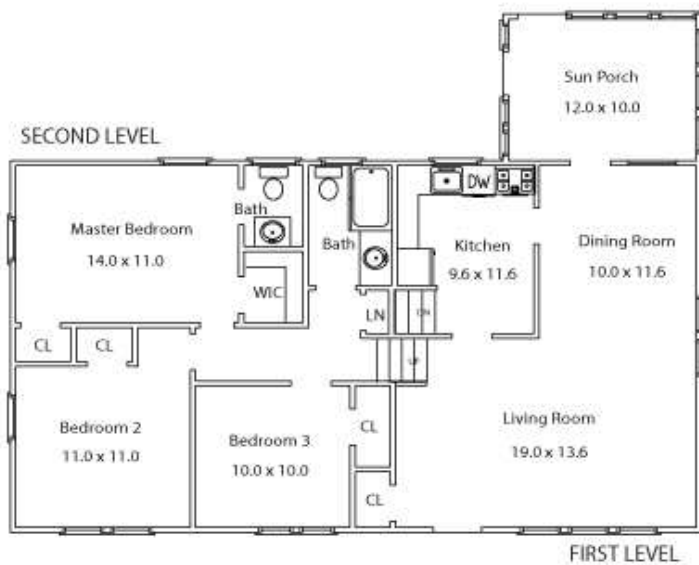

## ADDITIONAL FEATURES AND UPDATES

- Whole house hardwood floors
- New ground level bathroom
- Remodeled kitchen with stainless steel professional grade appliances.
- Crown molding throughout home
- Newer Furnace
- Anderson double hung windows
- Newer Roof

**140 Hillside** is just blocks from Schools, Downtown and the Train to NYC. This amazing location is hard to duplicate, and this move in ready home provides you the perfect opportunity to put your own stamp on a great Chatham home.

*Sue Adler*  
**KELLER WILLIAMS**  
 PREMIER PROPERTIES



**sueadler**   
 THE #1 KELLER WILLIAMS TEAM IN NEW JERSEY team

Cell: (973) 975-0197 Office: (973) 376-0033 x101  
 Email: Laurie@SueAdler.com ww.SueAdler.com/140Hillside