



*Sue Adler*  
**KELLER WILLIAMS**  
PREMIER PROPERTIES



Cell: (973) 975-0197  
Office: (973) 376-0033 x101  
Sue@sueadler.com  
[www.SueAdler.com/20midhurst](http://www.SueAdler.com/20midhurst)

**20 Midhurst Road**  
SHORT HILLS | NEW JERSEY



Each Keller Williams office is independently owned and operated.





*Period details and timeless appeal come together with thoughtful updates in this one-of-a-kind Tudor*

This Short Hills model Tudor is sure to impress any buyer! Located on a spacious corner lot in the sought after Knollwood section, this home boasts curb appeal, location (blocks to Millburn Middle School, train station and downtown) and both style and charm. Pull right into the circular driveway and walk up the front walkway and enter through the period correct arced entrance door surrounded by carved limestone and into the foyer where gleaming hardwood floors flow effortlessly under toe from one room to the next. Step down into the Living room where elegance and grandeur are apparent in every detail from the vaulted beam ceiling, leaded glass windows and doors to the wood paneled fireplace and limestone surround; creating a true focal point and a room sure to be the center of all your entertaining.

The open and rounded archway connects the Living room to the Dining room and can accommodate a dinner party of any size. The adjacent kitchen is perfectly placed next to the dining room and offers a bonus room with full bath, allowing you to create the perfect room for whatever you desire.

The open and flowing floor plan on the first level continues onto the second level, creating a place to retire to after a long day of work.







When the evening draws to a close, everyone will find their own personal retreat in one of three bedrooms.

The Master bedroom features painted, white hardwood flooring, custom built-in closets and dressing area. The Master bathroom has been updated with tile flooring, subway tile backsplash, marble top vanity and glass enclosed stall shower. The two additional bedrooms on this level are beautifully decorated, while the updated hall aptly services these bedrooms.



The lower level has been finished to create an urban chic vibe, complete with recreation room, laundry room and wine storage.

It is not often that home of this quality comes along. With little to do except bring your furnishings and personal touch, this is a fabulous opportunity to enjoy all Short Hills has to offer in complete comfort and style.



# Inside and Outside...

## FIRST LEVEL

- Inviting foyer with wood floor, crown molding and coat closet
- Dramatic Living room with wood floor, vaulted beam ceiling, leaded glass windows and doors, wood fireplace with wood panel surround
- Office off Living room with wall to wall carpet and vaulted ceiling
- Elegant dining room with hardwood floor, custom built-ins and crown molding
- Full bathroom with tile floor, crown molding and shower over tub
- Kitchen with white cabinetry, farm sink and wood floor
- Bonus room with wall to wall carpet and access to kitchen and entry foyer

## SECOND FLOOR

- Master bedroom with painted white hardwood floor, Juliet window overlooking the Living room, crown molding and custom built-in closets
- Master bath with tile floor, subway tile backsplash and enclosed glass stall shower
- Bedroom with hardwood floor, crown molding and closet
- Bedroom with hardwood floor and closet
- Full bath with tile floor, pedestal sink, subway tile backsplash and shower over tub

## LOWER LEVEL

- Recreation room with high gloss cement floor
- Powder room with tile floor
- Laundry Room
- Storage area

## The Floor Plan

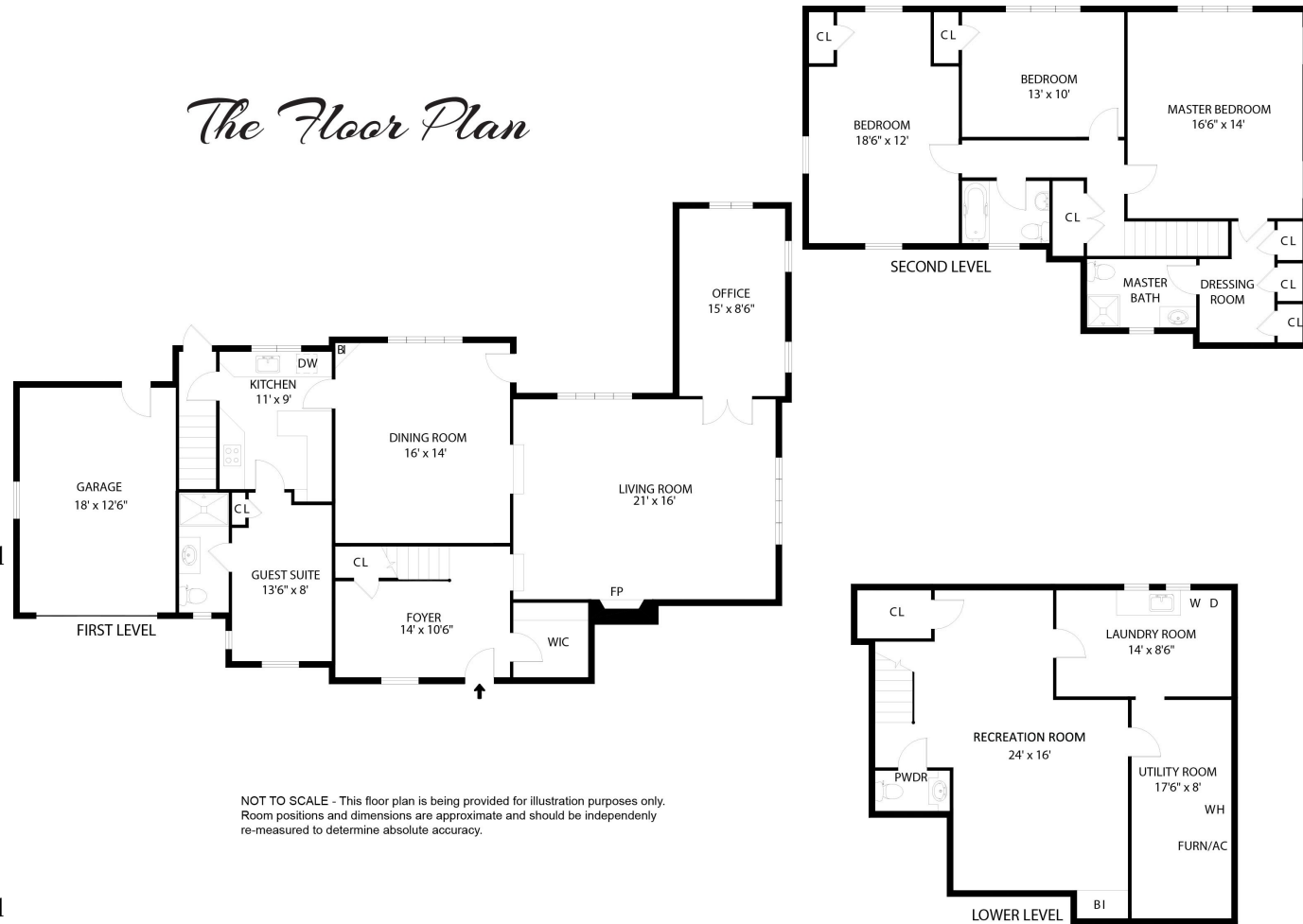

## ADDITIONAL FEATURES

- Newer windows throughout home
- Finished lower level and added powder room
- Refinished hardwood floors throughout home
- Added audio system throughout home
- Added bluestone patio in both the front and rear of the home
- Updated all bathrooms
- Alarm System
- Extensive landscaping

## PROPERTY PARTICULARS

Bedrooms: 4  
Bathrooms: 3.5  
Built: 1927  
Lot Size: 75 x 100  
Taxes: 17,858