

38 Westview Road

Short Hills, New Jersey



Sue Adler
KELLER WILLIAMS
PREMIER PROPERTIES

sueadler 
THE #1 KELLER WILLIAMS TEAM IN NEW JERSEY team

Each Keller Williams office is independently owned and operated.



Welcome to 38 Westview Road, a spacious split colonial set stately atop nearly an acre of property in one of Short Hills most sought after neighborhoods. Originally built in 1961, the home boasts numerous updates and the potential for so much more!

Upon arrival, you'll proceed up the curved walkway, through the handsome covered portico and into the welcoming Entry Foyer of this light filled home. Attractive hardwood floors lead you to each of the well-planned living and dining spaces found throughout the home. Directly ahead, through elegant French doors is a rich looking home office complete with a full wall of built-in shelving and a large picture window with backyard views. Through a broad archway to the left is the formal Living Room featuring an attractive wood burning fireplace with carved wood mantel and custom built-in shelving that's just waiting to be personalized with your favorite collectibles. The Living Room opens to the Dining Room for effortless entertaining. This large room is the perfect place to entertain family and guests who will surely enjoy meals prepared in the neighboring updated Kitchen. The Kitchen features custom cabinetry accented by high end appliances and attractive granite countertops. Enjoy the convenience of the built-in desk space and wet bar sink that sit opposite the spacious Breakfast Room with alluring backyard views.

At the end of the day, you'll proceed up the stairs to the second level where newly uncovered hardwood floors lead to 3 inviting bedrooms and 2 full baths to assure everyone's complete comfort. The Master Suite includes a spacious bedroom with plenty of closet space and a well-appointed en suite bath. 2 additional bedrooms with plenty of closet space enjoy easy access to the updated full Hall Bath featuring a large vanity with double sinks and faux marble top. Continue up just a few more steps to an expansive, fully plumbed 3rd level space that's just waiting for a new owner to define...create a private master suite, a children's play room or even an artist studio. The space is yours to use as you see fit!



A fabulous casual space is found in the lower level Family Room where a full wall custom built-in provides plenty of cabinets and drawers, 2 work stations that are ideal for homework assignments or daily paperwork, shelving that's just perfect for display of your favorite books and a dedicated space for a large screen TV. Gather round with friends to watch your favorite movie in this warm and inviting space. The lower level is also home to an elegant Powder Room and a fully equipped, conveniently located Laundry Alcove. An expansive unfinished basement level provides also provides options for your family's changing needs.

And there's more...continue on outdoors to your own two-level private backyard oasis. Here you can dine al fresco on the expansive brick paver patio before taking a dip in the custom designed free form pool nestled amid lush lawns, well planned shrubbery and a canopy of mature trees. Vacationing at home has never been more pleasing.

38 Westview Road boasts a sought-after location in an ideal family neighborhood that's near downtown shopping and restaurants. Access to Blue Ribbon schools and NYC transportation are icing on the cake! It's the perfect place to make your next home!

Inside and Out...

First Level

- Entry Foyer with wood door with glass sidelights, hardwood floors, coat closet, front-to-back views through Office, recessed lighting; broad archway to Living Room, French doors to Office and lower level
- Living Room with hardwood floors, crown molding, recessed lighting, large picture window with sheers, fireplace with wood mantel and painted brick surround, custom built-in to the left with display shelving and storage cabinets; doorway to Dining Room
- Dining Room with hardwood floors, chair rail, 2 windows, recessed lighting; swinging door to Kitchen
- Kitchen with ceramic tile floor, custom cabinetry with granite counter tops, Villeroy and Bach tile backsplash, Thermador double wall over, Sub Zero refrigerator/freezer with integrated cabinetry panel, GE Profile built-in microwave, GE Profile 4-burner cooktop, KitchenAid dishwasher, built-in desk with granite top, stainless steel sink with disposal and instant hot, supplemental bar sink, pantry with pullout drawers, broom closet; swinging door to Dining Room and open to Breakfast Room
- Breakfast Room with ceramic tile floor, chandelier and sliding doors to backyard
- Office with hardwood floors, recessed lighting, full wall built-in shelving, painted paneled walls, large picture window with wood shades, crown molding

Second Level

- Landing with hardwood floors, 2 linen closets with shelving, recessed lighting
- Master Bedroom Suite with hardwood floors, 3 windows, ceiling fan, recessed lighting, 2 walk-in closets with wire shelving, en suite bath with tile floor, vanity with Corian top, built-in mirrored medicine chest above and storage below, linen closet, stall shower with glass door and tiled walls, window with wood shutters
- Bedroom #2 with carpet (hardwood floors below), 3 windows with blinds (2 exposures), ceiling fan, recessed lighting, walk-in closet with wire shelving
- Bedroom #3 with carpet (hardwood floors below), double door closet, 2 windows with wood blinds, recessed lighting
- Hall Bath featuring 2 sink vanity with faux marble top and fully mirrored wall above, storage below, tile floor, built-in mirrored medicine cabinet, recessed lighting, separate commode and shower over tub with sliding glass door and tiled walls

Lower Level

- French door entry leads to hallway with hardwood floors, closet, access to Family Room, Powder Room, Laundry Alcove, Garage and Basement
- Laundry Alcove with slatted doors, Whirlpool front loading washer, Maytag dryer and utility sink
- Family Room with full wall custom built-in with 2 desks, storage cabinets and shelving, picture window, carpet, recessed lighting, custom window treatments, chair rail with paneling below
- Powder Room with marble tile, pedestal sink with glass shelf and mirrored medicine cabinet above, recessed light, window with wood shutters

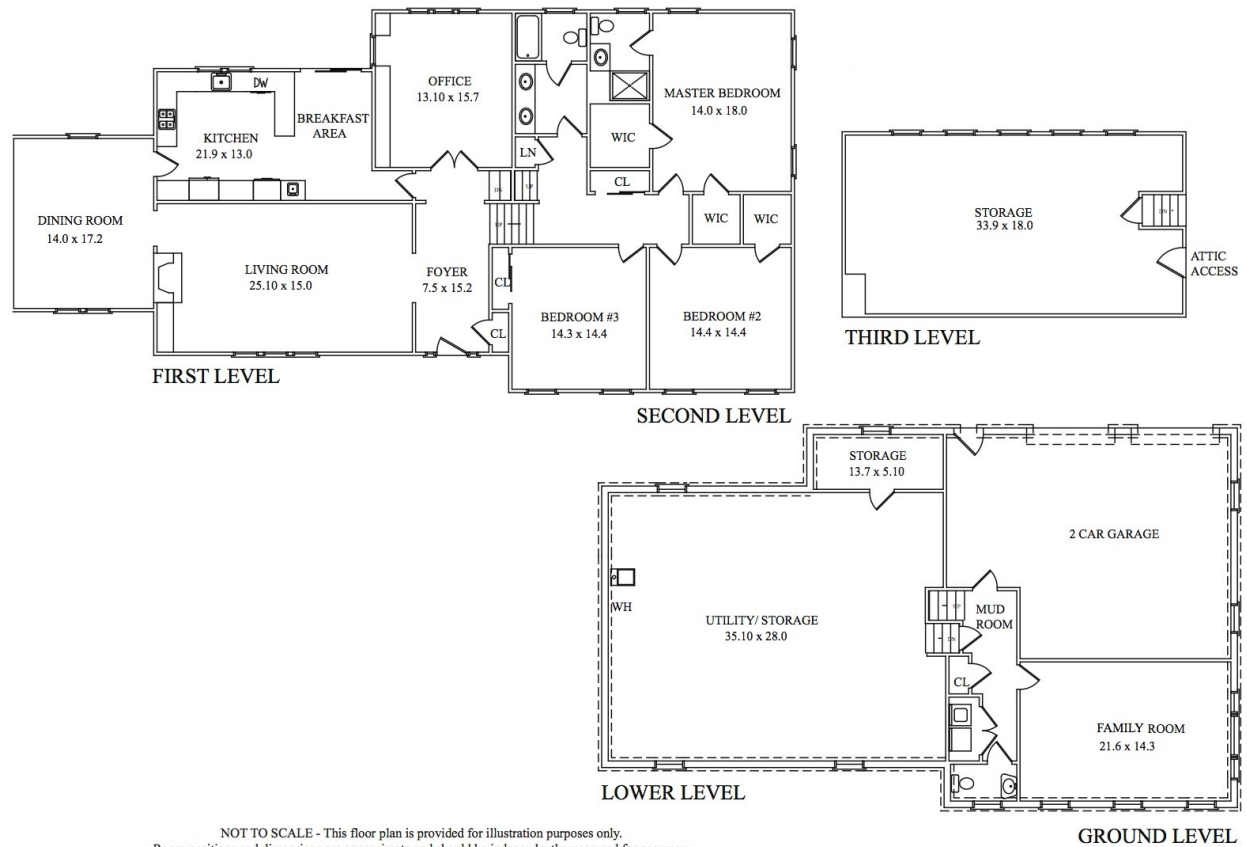

NOT TO SCALE - This floor plan is provided for illustration purposes only.
Room positions and dimensions are approximate and should be independently measured for accuracy.

Third Level

- Unfinished attic space with 5 windows plumbed for completion as a Master Suite

Basement

- Expansive unfinished space with storage room and access to utilities

Additional Features and Upgrades

- Professionally landscaped property with curved walkway to columned covered front entry, fully fenced in backyard featuring stone retaining walls, large brick paver patio with retractable awning and sun-drenched free form pool
- 2-car garage with electric doors, storage area with wire shelving and supplemental refrigerator
- 2-zone forced air heat/AC
- 85-gallon hot water heater

Sue Adler
KELLER WILLIAMS
PREMIER PROPERTIES



Cell: (973) 936-9129
Office: (973) 376-0033 x101
Sue@sueadler.com
www.sueadler.com/38Westview