

CONCORD DRIVE

50' WIDE R.O.W.
PER TAX MAP
CURB

$\Delta = 0^\circ 54' 56''$
 $R = 3755.25$
 $L = 60.00$
 $CH = N37^\circ 57' 43'' W$
 $CHL = 60.00$

BLOCK 4701 LOT 35(TM)
BLOCK 161A LOT 21(FM)

123.35'

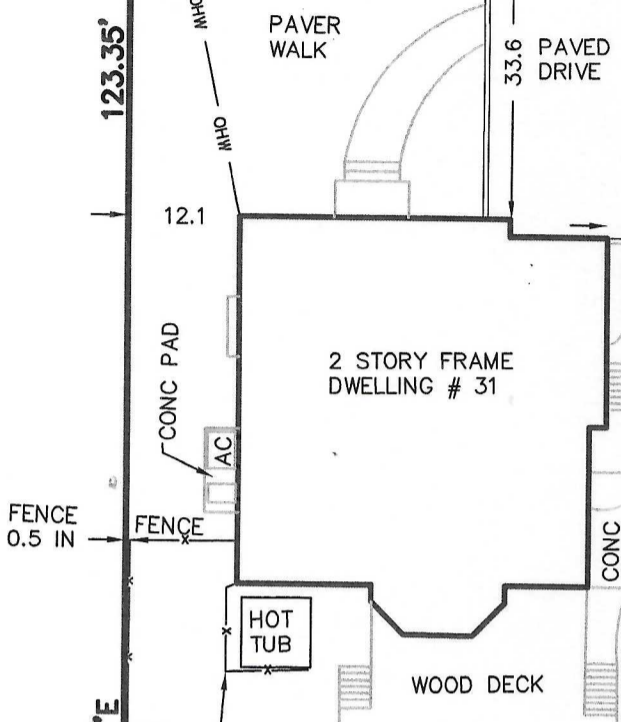

873.85'(TIE)

123.38'

BLOCK 4701 LOT 37(TM)
BLOCK 161A LOT 19(FM)

SOUTH LIVINGSTON AVENUE
66' WIDE R.O.W.
PER TAX MAP

N52°04'00"E

S52°04'00"W

BLOCK 4701 LOT 36(TM)
BLOCK 161A LOT 20(FM)

N37°56'00"W 60.00'

BLOCK 4701 LOT 16

BLOCK 4701 LOT 15

- NOTES:
1. LOT AREA = 7,407 SQ.FT. or 0.17 Acres
 2. BEING COMMONLY KNOWN AS 31 CONCORD DRIVE LIVINGSTON, NEW JERSEY
 3. SUBSURFACE CONDITIONS ARE NOT SHOWN OR CERTIFIED

SURVEY OF LANDS IN: TOWNSHIP OF LIVINGSTON, ESSEX COUNTY, NEW JERSEY LOT 36 BLOCK 4701

REFERENCE: DEED BOOK 6294 PAGE 374, FM 1650
DESCRIPTION:

Scale: 1" = 20'

DATE: 08/03/09

PMC LAND SURVEYING
11 Saxton Drive
Hackettstown, NJ 07840

TEL: 908-850-4304 FAX: 908-850-4305

Patrick A. Cibellis, Jr.
PATRICK A. CIBELLIS, JR.

PROFESSIONAL LAND SURVEYOR LIC. No. GS43228

SUBJECT TO MUNICIPAL RESTRICTIONS, EASEMENTS OF RECORD AND OTHER FACTS WHICH A TITLE SEARCH MIGHT DISCLOSE. CERTIFIED TO BE IN ACCORDANCE WITH PERTINENT NEW JERSEY LAWS AND REGULATIONS AND WITH CURRENT ACCURACY STANDARDS ONLY TO:

DIANE GOLDMAN, UNMARRIED
PROPERTY TITLE GROUP, LLC
STEWART TITLE GUARANTY COMPANY
WORLDWIDE FINANCIAL RESOURCES, INC., ITS SUCCESSORS
AND/OR ASSIGNS AS THEIR INTERESTS MAY APPEAR
STIEBER & VELORIC, LLC

Revisions: 0

Project # 090717

File No. DC003077