

PROPERTY KNOWN AS LOT #14 AS SHOWN ON
 "MAP OF WOODFIELD SHORT HILLS ESTATES" FILED
 FEBRUARY 8, 1927 AS MAP #1014.

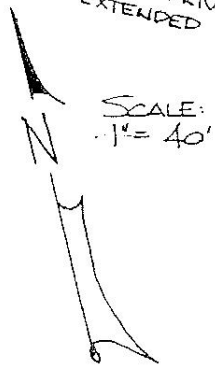

THIS SURVEY IS CERTIFIED TO JAMES GIBBONS AND
 ELIZABETH GIBBONS, HIS WIFE, LAWYERS TITLE INSURANCE
 CORPORATION CHASE MANHATTAN FINANCIAL SERVICES, INC.
 AND/OR ITS ASSIGNS, AND BRENER, WALLACK, & HILL, ATTORNEYS.

SINGER-MURPHY ASSOCIATES, INC.

PROFESSIONAL LAND SURVEYORS
 P.O. BOX 505, 90 NORTH AVENUE, FAIRWOOD, NEW JERSEY 07023

LOCATION SURVEY of PROPERTY AT:
 #17 OAKLAWN ROAD
 TOWNSHIP of MILLBURN
 ESSEX Co., NEW JERSEY

Paul R. Murphy
 PAUL R. MURPHY, PLS # 30091
 JULY 18, 1986

86-839 NO PROPERTY MARKERS
 SET OR REQUESTED

120079