



55 Karen Way

Summit, New Jersey





Welcome to 55 Karen Way! This BRIGHT AND AIRY 3 Bedroom, 2 Bath home sits in Summit's Washington Elementary School District, a short distance to recreational pursuits at Tatlock Park, Route 24, Midtown Direct Train and all downtown Summit has to offer.

As you arrive, take in this charming home sitting beautifully on a quiet cul de sac great for play and block parties. This home is open and airy, freshly painted with neutral hues and has a desirable open floorplan. Enter through the front door and into the warm and welcoming Living Room. Admire the stunning vaulted ceiling and bay window where the sunlight pours in.





The Living Room opens to the cheery Family Room perfect for watching TV or curling up with a novel. A French door opens up to a lovely Patio Area, enclosed by a charming picket fence, perfect for outdoor cocktails or summer meals. The rest of the fenced in backyard offers plenty of flat space for play, fire pits and time spent with friends. Back inside the home you will find even more opportunity to entertain in the stately Dining Room featuring hardwood floors, a cool pendant light fixture with glass globes and plenty of room to spread out. Move into the fabulous Kitchen sure to impress any chef. Crisp white cabinets, granite countertops, wine storage and stainless appliances are the best in form and function.





Go down a few steps and get ready to settle in for play or working from home in the Lower Level Recreation Room/Office. Conveniently located off of the Family Room is a large-sized Laundry/Utility Room and a spacious 1 Car Garage.

Ready to retire for the evening? Flow upstairs to the Primary Bedroom Suite featuring a Walk In Closet, neutral hues, windows at 2 exposures and a well-appointed Bath. Bedrooms 2 and 3 are sundrenched and include plenty of closet space. A Hallway Full Bath features a NEW vanity and tasteful tile throughout.

55 Karen Way is the perfect starter home in one of New Jersey's most sought-after towns. With easy access to restaurants and shopping, proximity to Tatlock Park, Washington Elementary, Midtown Direct train and Summit's outstanding restaurants and shops, this home is a must see!



INSIDE & OUT

FIRST LEVEL

- Entryway featuring original wood door, Coat Closet
- Living Room featuring vaulted ceiling, hardwood floors, bay window, recessed lighting, open to Dining Room
- Family Room featuring vaulted ceiling, hardwood floors, door to side yard, recessed lighting, baseboard molding, 3 windows
- Dining Room featuring vaulted ceiling, 3 windows, hardwood floors, light with 3 pendant glass shades, hardwood floors, baseboard molding, open to Living Room and Kitchen
- RENOVATED Chef's Kitchen featuring hardwood floors, custom cabinetry including built in wine storage, granite countertops, mosaic tile backsplash, Frigidaire stainless 4 burner oven/range, Frigidaire stainless refrigerator/freezer, Frigidaire stainless dishwasher, stainless hood, stainless sink, vaulted ceiling, recessed lighting, window, microwave nook, door to Lower Level

SECOND LEVEL

- Second Level Landing featuring hardwood floors, vaulted ceiling, recessed lighting, baseboard molding, Linen Closet
- Primary Bedroom Suite featuring hardwood floors, vaulted ceiling, windows at 2 exposures, recessed lighting, oversized Closet, baseboard molding, Bathroom featuring wood look flooring, pedestal sink, glass door shower with tile surround, window, recessed lighting, medicine cabinet
- Bedroom 2 featuring vaulted ceiling, hardwood floors, windows at 2 exposures, 2 Closets, baseboard molding
- Bedroom 3 featuring vaulted ceiling, hardwood floors, 2 windows, Closet, baseboard molding
- Full Hall Bath featuring tile flooring, vaulted ceiling, NEW vanity, tub/shower combination with tile surround, recessed lighting, window

LOWER LEVEL

- Carpeted staircase to Lower Level
- Recreation Room/Office featuring tile flooring, 2 windows, recessed lights, eave storage, baseboard molding
- Laundry/Utility Room featuring utility sink, GE washer, Whirlpool dryer, door to driveway
- 1 Car Garage with storage
- Sump pumps

FRONT & BACK YARD

- Patio with picket fence surround
- Pea gravel/paver area for BBQ and firepit
- Flat grassy areas for play
- Storage shed
- Fenced in yard with NEW perimeter fence
- NEW decking
- Swingset Solutions Play Set
- Irrigation

ADDITIONAL FEATURES & UPGRADES

- NEW recessed lighting and switches throughout
- NEW electric garage door
- Freshly painted neutral hues throughout (2022)
- Alarm system



FIRST LEVEL

SECOND LEVEL

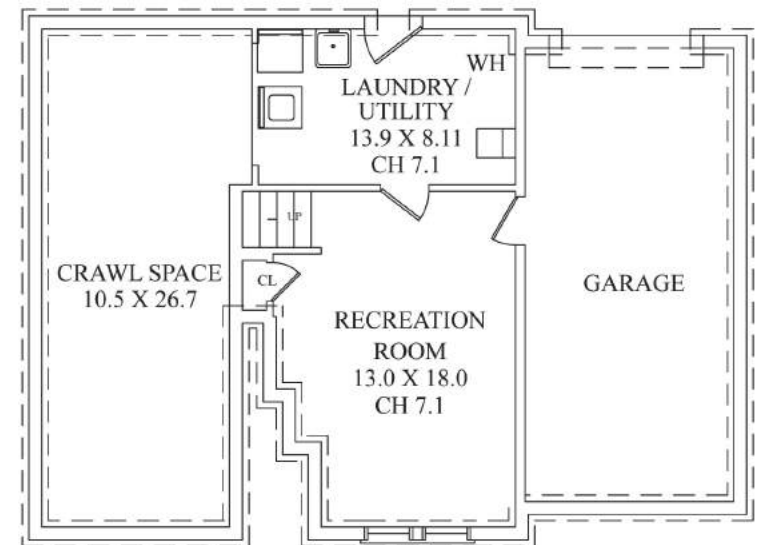

LOWER LEVEL

THE FLOORPLAN

*NOT TO SCALE - This floor plan is provided for illustration purposes only.
Room positions and dimensions are approximate and should be independently measured for accuracy.*



sueadler 
THE #1 KELLER WILLIAMS TEAM IN NEW JERSEY team

CELL: 973.936.9129
OFFICE: 973.376.0033 x101
EMAIL: info@sueadler.com
sueadler.com/55Karen

kw PREMIERE
PROPERTIES
KELLERWILLIAMS

Each Keller Williams office is individually owned and operated.