



165 Hillside Avenue
Chatham, NJ



Welcome to 165 Hillside Avenue! This Like New DARLING 4 Bedroom, 3 Full, 2 Half Bath home, on a sought after street and located close to Midtown Direct Train and downtown Chatham, hits all the right notes. Just pack your bags, this house is ready to be called home.



Drive up to 165 Hillside and take in all the charm of this home. Delightful shutters, beautiful greenery and a welcoming Front Porch all lend to the home's curb appeal. Step inside the welcoming front door to find the blissful, sun drenched Entry Foyer flowing easily into both the Living and Dining Rooms. Move easily into the Living Room with large windows, hardwood floors and neutral tones. Dinner parties are a dream in the elegant Formal Dining Room with a graceful bay of windows and regal wainscoting.





Flow easily into the Gourmet Chef's Kitchen sure to impress any chef. Custom cabinetry, a large island/breakfast bar, marble countertops and high-end stainless appliances are the best in form and function. The Kitchen opens desirably to the gorgeous Family Room perfect for movie night and family gatherings. A cozy fireplace and outstanding views of the property make this room extraordinary. A French door leads to a lovely Deck with outstanding views of the lush, private property. A tasteful Powder Room rounds out the First Level.



When you are ready to retire for the evening, take the gracious staircase to the Second Level. The Primary Bedroom Suite dazzles with windows at two exposures, two Walk In Closets and a spa-like Bath. Move easily down the hallway where two other sunny bedrooms with ample closet space await. Laundry is a snap when you have a Second Level Laundry Room. A tasteful Full Hall Bath rounds out this level. Take a few steps upstairs to the spacious Third Level where you will find Bedroom 4 which could be used as a bedroom, office, media room...your choice! A well appointed full bath makes this space even more convenient.



And that's not all! The Lower Level boasts a Recreation Room perfect for X-Box, hangouts or play time. A large Mud Room means everything will be neatly tucked away. A Garage and Half Bath round out this level.

With its incredible neighborhood, top notch schools, New York City Midtown Direct Train and convenience to fantastic shopping and restaurants in Chatham and Madison, 165 Hillside is an absolute must see!



INSIDE & OUT

FIRST LEVEL

- Entry Foyer featuring hardwood floors, Double Door Closet, wainscoting, crown molding, staircase to Second Level, recessed lighting, French door to Lower Level
- Living Room featuring hardwood floors, oversized windows at 2 exposures, semi pendant light with drum shade, crown molding, baseboard molding
- Dining Room featuring hardwood floors, wainscoting, bay of windows, crown molding, chandelier, open to Foyer and Living Room
- Gourmet Chef's Kitchen featuring hardwood floors, custom white cabinetry including glass door cabinetry, marble countertops, island/breakfast bar with seating for 4, pendant lighting, recessed lighting, high-end stainless appliances and hood, Breakfast Area with pendant light with drum shade
- Family Room featuring fireplace with custom millwork mantle and stone surround, recessed shelving nook, French door to Deck, recessed lighting
- Powder Room featuring hardwood floors, bead board wainscoting, vanity, designer light fixture

LOWER LEVEL

- Recreation Room featuring carpeting, Double Door Closet, recessed lighting, baseboard molding
- Mud Room featuring tile flooring and storage, door to outside, recessed lighting, baseboard molding, door to Garage
- Garage with carriage style, automatic door
- Half Bath featuring tile flooring, pedestal sink, baseboard molding

ADDITIONAL FEATURES/UPGRADES

- Energy efficient construction, low maintenance
- Hardie plank siding
- Pella windows
- Timberline dimensional roof
- Central vacuum system
- Alarm system
- Digital, programmable thermostats
- Wired for cable
- Water softener
- Honeywell whole house humidifier

SECOND LEVEL

- Primary Bedroom Suite featuring hardwood floors, windows at 2 exposures, 2 Walk In Closets, recessed lighting, chandelier
- Primary Bath featuring tile flooring, oversized shower with glass door and designer tile, double vanity with marble countertop, sconces over sink, recessed lighting
- Bedroom 2 featuring hardwood floors, bay of windows, Double Door Closet, flush mount light fixture, crown molding, baseboard molding
- Bedroom 3 featuring hardwood floors, windows at 2 exposures, flush mount light fixture, Double Door Closet, crown molding, baseboard molding
- Full Hall Bath featuring tile flooring, tub/shower combination, custom double vanity with stone countertop, recessed lighting, sconces over sink
- Laundry Room featuring tile flooring, utility sink, LG stainless front loader washer and dryer

THIRD LEVEL

- Bedroom 4/Office featuring vaulted ceiling, hardwood floors, recessed lighting, baseboard molding
- Full Bath featuring tile flooring, frameless glass door shower with designer tile surround, vanity, linen closet, recessed lighting, sconces

FRONT/BACKYARD

- Front Porch with wood flooring, bead board ceiling, decorative lanterns
- Professional landscaping
- Deck
- Private backyard with natural fence of mature arbor vitae
- Storage Shed

THE FLOORPLAN



FIRST LEVEL



SECOND LEVEL



THIRD LEVEL

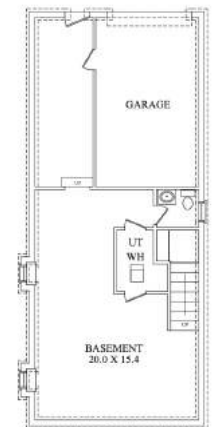

LOWER LEVEL



CELL: 973.936.9129

OFFICE: 973.376.0033 x101

EMAIL: info@sueadler.com

sueadler.com/165Hillside



Each Keller Williams office is individually owned and operated.

