

kw PREMIER
PROPERTIES
KELLERWILLIAMS
*Each Keller Williams office is
individually owned and operated.*

PRESENTED BY
sueadler 
THE #1 KELLER WILLIAMS TEAM IN NEW JERSEY **team**



511 Melrose Place
South Orange, New Jersey



Drive up to 511 Melrose and you are transported to another time and place. This exquisite 4 Bedroom, 1 with en-suite Sitting Room (can be used as a potential 5th Bedroom or an Office), 3 Full, 2 Half Bath expanded cape (that looks and feels more like a spacious center hall colonial), in the heart of South Orange's coveted Melrose neighborhood, boasts gorgeous period details blended with utterly stunning renovations. Enjoy the home's incredible hallmarks including lovely moldings, hardwood floors, an open and airy floor plan and magical English gardens.

As you arrive, take in the home's meticulous and thoughtful landscaping and how it sits majestically on the property. Flower boxes are just waiting for you to plant your favorite blooms. Enter through the welcoming front door adorned by original leaded glass sidelites. An Entry Vestibule leads to the bright and airy Entry Foyer complete with period moldings, an elegant staircase and views of the Living and Dining Rooms beyond. The spacious and sundrenched Living Room is an entertainer's dream with its gorgeous original wood burning fireplace, windows at two exposures, and plenty of room to host family and friends. Dinner parties are divine in the elegant Formal Dining Room complete with regal wainscoting and an original China Cabinet to display all your family heirlooms.



The Chef's Gourmet Kitchen dazzles with washed wood cabinetry, high-end Viking/Bosch/LG stainless appliances and an oversized island with seating. A Walk In Pantry, tons of storage, open wine storage and a designated Desk Area only add to the room's appeal. Prepare to be impressed by the stunning Family Room Addition certain to be the heart of the home. This spacious, L-shaped room includes plenty of room for TV watching, family game night or just hanging out with friends. French doors and oversized casement windows bring the sunshine in and offer breathtaking views of the outdoor gardens. The backyard is easily accessed from the Family Room and Kitchen, making indoor and outdoor entertaining seamless. A tasteful Powder Room and 2 Car Garage round out the First Level.





Ready to retire for the evening? Take the graceful stairway to the Second Floor Landing complete with a Linen Closet providing ample storage. Enjoy privacy and gorgeous architectural details in the spacious Primary Bedroom Suite complete with two Closets, a Sitting Area and a spacious bath with cool vintage tile. There is another ensuite Bedroom with tons of closet space, a Sitting Room and a tasteful Bath. The remaining two bedrooms are generously sized and sundrenched. These bedrooms share a well-appointed Full Hall Bath with chic vintage tile.



And that's not all! The Lower Level provides plenty of additional living space with a Recreation Room/Children's Playroom (flexibly being used as an Office) with chic wood look flooring. Working out is a pleasure in the adjacent Exercise Room. A large Laundry/Utility/Storage Room and a Half Bath round out the Lower Level. There is also egress from the laundry area through a custom installed Bilco door.

Another showstopper of 511 Melrose is the exquisite property beautifully maintained and planted to perfection. The backyard, with its thoughtful use of pea gravel and abundant perennial gardens, radiates absolute serenity. Whether it's admiring the garden, hanging by a fire pit or barbecuing, there is room for it all!

With its prestigious neighborhood, proximity to the Jitney and Midtown Direct Train, convenience to South Orange's fantastic shopping and restaurants, 511 Melrose is an absolute must see.



INSIDE & OUT

FIRST LEVEL

- Entry Vestibule featuring entry door surrounded by original beaded glass sidelites, hardwood floors, baseboard molding, crown molding with dentil detail, flush mount light, French door into Entry Foyer
- Entry Foyer featuring hardwood floors, semi-flush light fixture, baseboard molding, crown molding with dentil detail, staircase to Second Level
- Dining Room featuring hardwood floors, wainscoting, windows at 2 exposures, original built in China Cabinet, pendant light fixture, crown molding with dentil detail
- Living Room featuring hardwood floors, original fireplace with custom millwork mantle and brick surround/hearth, windows at 2 exposures, baseboard molding, crown molding with dentil detail
- Gourmet Chef's Kitchen featuring tile flooring, custom Brookhaven wood cabinetry including glass door cabinetry, large island with seating, granite countertops, tile backsplash, decorative tile backsplash behind oven, LG stainless refrigerator/freezer with exterior ice/water, Viking stainless 6 burner oven/range, Best stainless hood, Bosch stainless dishwasher, GE stainless built in microwave, built in Desk Area, free standing cherry sideboard and matching overhead plate rack, double stainless sink, large double window over sink with ledge, Walk In Pantry, open wine storage, open storage for large platters/cutting boards, open shelf above refrigerator, doorway leading to hallway to Garage, Back Door and Rear Staircase
- Rear Hallway featuring tile flooring, recessed lighting, large Storage Closet, baseboard molding
- Powder Room featuring tile flooring, pedestal sink, mosaic backsplash, 2 light sconce, window, baseboard molding, crown molding with dentil detail
- Family Room Addition featuring maple hardwood floors, partially vaulted ceiling, double French doors to new Timbertech Deck, recessed lighting, baseboard molding, crown molding with dentil detail, brick accent wall, Area for Lounging/TV, Area for Dining/Cards/Games, windows at 3 exposures
- 2 Car Garage with electric doors, storage, new steel door exit to backyard, and windows at two exposures

SECOND LEVEL

- Staircase with runner to Second Level
- Second Level Landing featuring hardwood floors, baseboard molding, Linen Closet
- Primary Bedroom Suite featuring hardwood floors, partially vaulted ceiling, Sitting Area, 2 extra-large Closets, 2 dormer areas, built in open shelving, baseboard molding, windows at 2 exposures, Bath featuring cool vintage tile flooring and wainscoting, pedestal sink, large Storage Closet, medicine cabinet, sconces, flush mount light, tub/shower combination with tile surround, window, wall mount cabinet
- Bedroom 2 featuring carpeting, windows at 2 exposures, partially vaulted ceiling, extra-large Closet with built in open shelving, baseboard molding, flush mount lighting
- Ensuite Bedroom 3 featuring hardwood floors with adjacent Sitting Room and Closet, baseboard molding, flush mount light, 2 windows, hallway to bedroom and bath. Full Bath featuring hexagonal floor tile, tub/shower combination with tile surround and beadboard detail on bath exterior, pedestal sink, hanging cabinet, window, flush mount light. Bedroom Area featuring partially vaulted ceiling, hardwood floors, windows at 2 exposures, track lighting, door to Rear Staircase, door to Eave Storage, 2 Closets
- Full Hall Bath featuring vintage floor tile and wainscoting, pedestal sink, tub/shower combination with tile surround, window, medicine cabinet, flush mount lighting
- Bedroom 4 featuring carpeting, windows at 2 exposures, partially vaulted ceiling, Walk In Closet, recessed lighting, baseboard molding, built-in shelving

LOWER LEVEL

- Wood staircase to Lower Level
- Recreation Room (flexibly being used as Office) featuring laminate wood look flooring, paneled walls, flush mount lighting, baseboard molding, 2 Closets
- Exercise Room featuring laminate wood look flooring, paneled walls, flush mount lighting, baseboard molding
- Storage/Utility Room with water heater/boiler
- Half Bath featuring laminate flooring, pedestal sink with tile backsplash, glass shelf, flush mount light

INSIDE & OUT

LOWER LEVEL CONT...

- Under stairs Storage Closet
- Laundry Room featuring laminate flooring, Built In Storage Closets, utility sink, LG front loader washer and dryer on stands, flush mount lighting
- Rear Door leading to Bilco Doors

ADDITIONAL FEATURES/UPGRADES

- Freshly painted interior and exterior
- New shutters
- Newer roof
- Newer stone front staircase
- Newer Bilco door entrance to Basement
- Newer Timbertech Deck (maintenance-free)
- New LG stainless refrigerator/freezer with exterior ice/water
- New Bosch stainless dishwasher
- Puron AC
- Replacement tilt wash Andersen windows and casement Andersen windows
- Newer pedestal sinks and medicine cabinets in Primary and Hall Bath
- Partially renovated Bathroom in Bedroom 3
- Energy efficient home
- Hardwood flooring under carpeting
- All systems meticulously maintained
- Newer electrical panel and line
- Newer waste disposal and stove faucet
- Driveway resealed

FRONT YARD / BACKYARD

- Meticulously and professionally landscaped
- Large driveway with parking for 2 cars side by side
- Stone winding front walkway
- Stone front staircase
- Fenced in yard
- Rear English Gardens, pea graveled areas with multiple zones for conversation areas, dining, barbequing
- Beautifully encased by thoughtful plantings, ornamental trees (Japanese Maple, Korean Dogwood and Stewartia) and shade perennials
- Bluestone stepping stones
- Irrigation system

THE FLOORPLAN

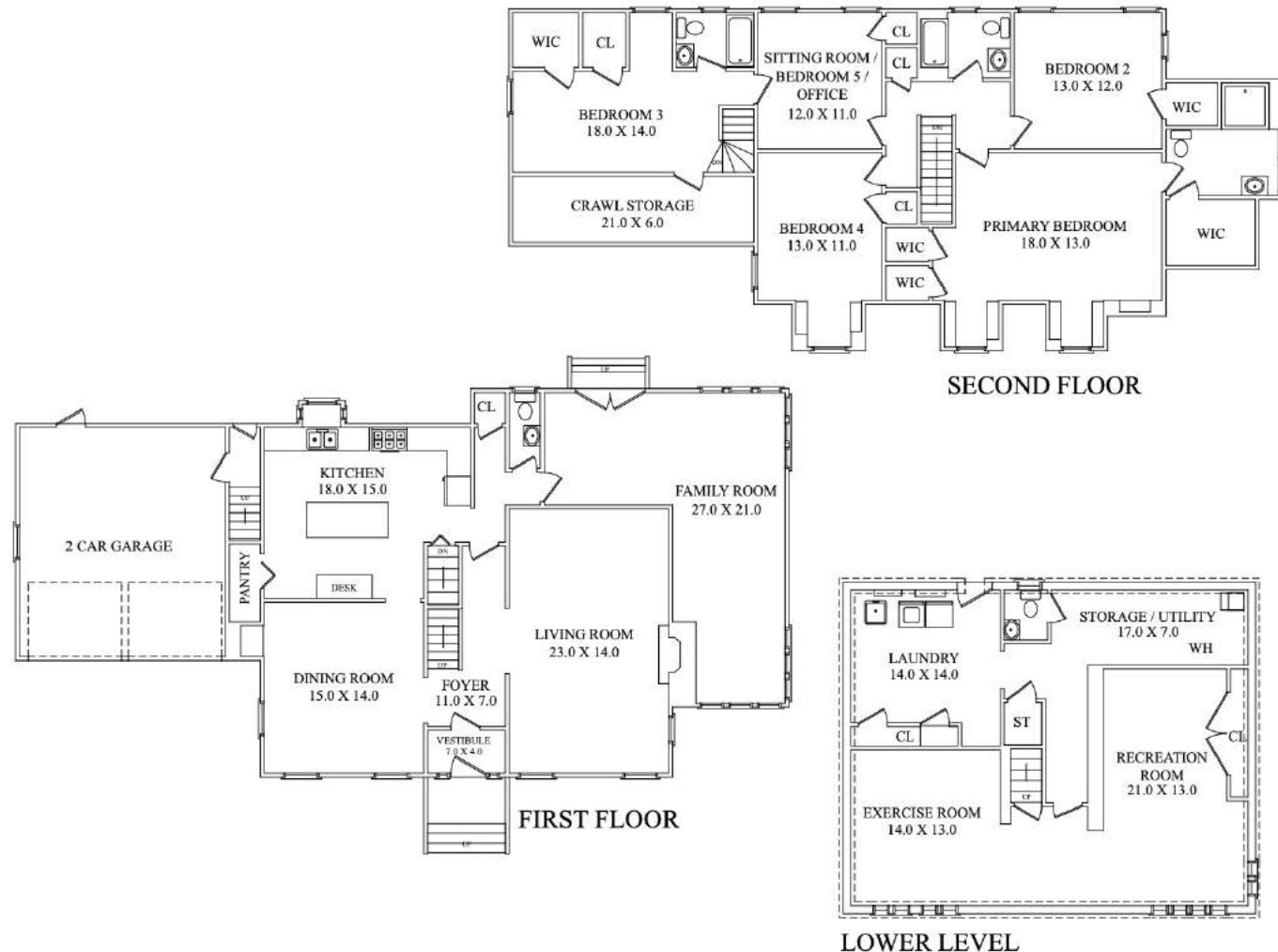

NOT TO SCALE - This floor plan is provided for illustration purposes only.
 Room positions and dimensions are approximate and should be independently measured for accuracy



PRESENTED BY
sueadler 
THE #1 KELLER WILLIAMS TEAM IN NEW JERSEY **team**

kw PREMIER
PROPERTIES
KELLERWILLIAMS.

Each Keller Williams office is individually owned and operated.



Larry Chiger
Listing Specialist

Cell: 973.936.9129

Office: 973.376.0033 ext.101

E-mail: info@sueadler.com

sueadler.com/511Melrose